

Paranchi elettrici a catena serie KF

KF series electric chain hoists

KITO

TIPO KF/3
Con carrello elettrico

KF/3 TYPE
With electric trolley

CARATTERISTICHE SPECIFICATION

- Power supply 230-400V / 50-60Hz
- Control Voltage 48 V
- IP 54 enclosure protection
- Galvanized chain resistant to fatigue and wear
- Trolleys wheels with life lubricated wheels
- Single shaft trolley to share the load on the 4 wheels
- Lugs provide protection from falling off the rail
- Rubber bumpers
- Wheels profile suitable for flat or tapered beams
- Electric travelling limit switch

- Alimentazione 230-400V / 50-60Hz
- Apparecchiatura in bassa tensione 48 V
- Protezione IP 54
- Catena zincata resistente alla corrosione e alla fatica
- Sacco portacatena
- Ruote carrello su cuscinetti lubrificati a vita
- Carico sempre distribuito sulle 4 ruote poiché le piastre ruotano sul perno del carrello
- Staffe anticarrucolamento
- Respingenti in gomma
- Idonei a scorrere su travi ad ali piatte o inclinate grazie al profilo delle ruote
- Finecorsa elettrico di traslazione

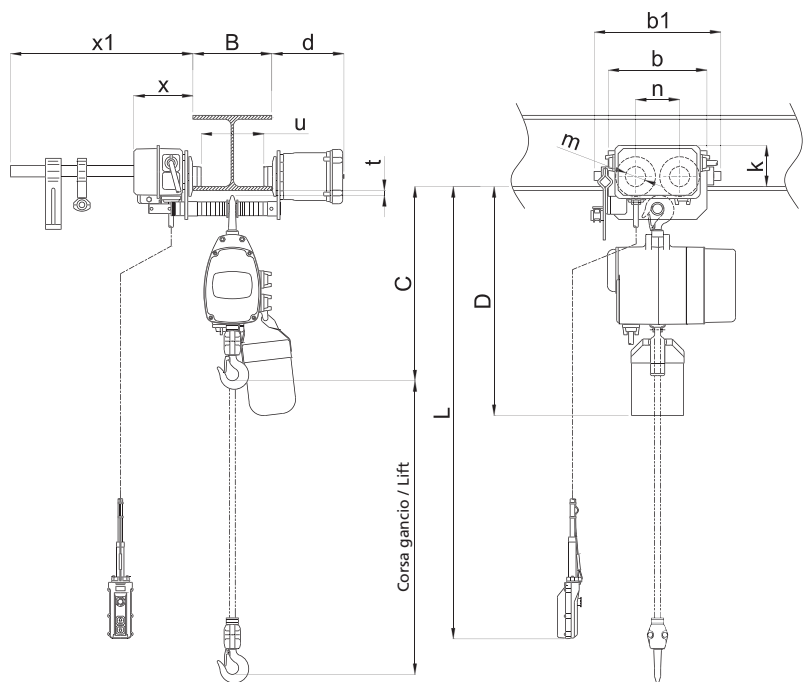

DATI TECNICI TECHNICAL DATA

	Portata WLL t	Tipo Type	Corsa gancio STD Std lift m	Cavo pulsantiera STD L Std push button cord m	Velocità sollevamento Lifting speed 50 Hz m/min.	Motore sollevamento Lifting motor		Velocità traslazione Traversing speed 50 Hz m/min.	Motore traslazione Traversing motor		Larghezza trave B Flange width B		Raggio minimo curvatura Min. radius curve mm	Peso netto Net weight Kg	Peso per ogni metro addizionale di corsa gancio Weight for additional one meter of lift Kg
						Potenza Output kW	R.I. ED %		Potenza Output kW	R.I. ED %	Standard mm	Option mm			
1 vel. sollev. 1 speed	125 kg	KF 20S1/3	3.0	2.5	8.0	0.45	50	10 o 20	0.10 o 0.30	40	58÷127	128÷305	1500	56	0,55
	250 kg	KF 20S2/3	3.0	2.5	4.0	0.45	50	10 o 20	0.10 o 0.30	40	58÷127	128÷305	1500	60	1,10
	250 kg	KF 25S1/3	3.0	2.5	8.0	0.45	50	10 o 20	0.10 o 0.30	40	58÷127	128÷305	1500	56	0,55
	500 kg	KF 25S2/3	3.0	2.5	4.0	0.45	50	10 o 20	0.10 o 0.30	40	58÷127	128÷305	1500	60	1,10
	500 kg	KF 50S1/3	3.0	2.5	7.0	0.80	50	10 o 20	0.10 o 0.30	40	58÷127	128÷305	1500	69	0,85
	1	KF 50S2/3	3.0	2.5	3.5	0.80	50	10 o 20	0.10 o 0.30	40	58÷153	154÷305	1500	80	1,70
	1	KF 100S1/3	3.0	2.5	6.5	1.50	50	10 o 20	0.10 o 0.30	40	58÷153	154÷305	1500	90	1,10
	2	KF 100S2/3	3.0	2.5	3.3	1.50	50	10 o 20	0.15 o 0.40	40	100÷178	179÷305	2000	112	2,20
2 vel. sollev. 2 speed	125 kg	KF 20S1A/3	3.0	2.5	8.0/2.7	0.45/0.15	40/40	10 o 20	0.10 o 0.30	40	58÷127	128÷305	1500	56	0,55
	250 kg	KF 20S2A/3	3.0	2.5	4.0/1.3	0.45/0.15	40/40	10 o 20	0.10 o 0.30	40	58÷127	128÷305	1500	60	1,10
	250 kg	KF 25S1A/3	3.0	2.5	8.0/2.7	0.45/0.15	40/40	10 o 20	0.10 o 0.30	40	58÷127	128÷305	1500	56	0,55
	500 kg	KF 25S2A/3	3.0	2.5	4.0/1.3	0.45/0.15	40/40	10 o 20	0.10 o 0.30	40	58÷127	128÷305	1500	60	1,10
	500 kg	KF 50S1A/3	3.0	2.5	7.0/2.3	0.80/0.27	40/40	10 o 20	0.10 o 0.30	40	58÷127	128÷305	1500	69	0,85
	1	KF 50S2A/3	3.0	2.5	3.5/1.2	0.80/0.27	40/40	10 o 20	0.10 o 0.30	40	58÷153	154÷305	1500	80	1,70
	1	KF 100S1A/3	3.0	2.5	6.5/2.2	1.50/0.50	40/40	10 o 20	0.10 o 0.30	40	58÷153	154÷305	1500	91	1,10
	2	KF 100S2A/3	3.0	2.5	3.3/1.1	1.50/0.50	40/40	10 o 20	0.15 o 0.40	40	100÷178	179÷305	2000	113	2,20

- Tutti i modelli sono disponibili con comando diretto o in bassa tensione. Su richiesta carrelli per raggi di curva inferiori.
- All models available with direct voltage or low voltage. Upon demand available trolleys for smaller radius curve.

	Portata WLL t	Tipo Type	Ingombro minimo Min headroom		Dimensioni Dimensions										
			C mm	D mm	b mm	b1 mm	d mm	g mm	k mm	m mm	n mm	t mm	u mm	x mm	x1 mm
1 vel. sollev. 1 speed	125 kg	KF 20S1/3	550	650 [740]	276	355	201	24	115	56	123	24	B-45	165	510
	250 kg	KF 20S2/3	590	650 [740]	276	355	201	24	115	56	123	24	B-45	165	510
	250 kg	KF 25S1/3	550	650 [740]	276	355	201	24	115	56	123	24	B-45	165	510
	500 kg	KF 25S2/3	590	650 [740]	276	355	201	24	115	56	123	24	B-45	165	510
	500 kg	KF 50S1/3	600	790 [870]	276	355	201	34	115	56	123	24	B-45	165	510
	1	KF 50S2/3	685	810 [890]	306	385	203	31	111.5	63	136	23	B-49	167.5	510
	1	KF 100S1/3	675	915 [955]	306	385	203	31	111.5	63	136	23	B-49	167.5	510
	2	KF 100S2/3	860	1030 [1070]	342	395	236	37	124.5	75	150	31	B-56	171.5	510
2 vel. sollev. 2 speed	125 kg	KF 20S1A/3	550	650 [740]	276	355	201	24	115	56	123	24	B-45	165	510
	250 kg	KF 20S2A/3	590	650 [740]	276	355	201	24	115	56	123	24	B-45	165	510
	250 kg	KF 25S1A/3	550	650 [740]	276	355	201	24	115	56	123	24	B-45	165	510
	500 kg	KF 25S2A/3	590	650 [740]	276	355	201	24	115	56	123	24	B-45	165	510
	500 kg	KF 50S1A/3	600	790 [870]	276	355	201	34	115	56	123	24	B-45	165	510
	1	KF 50S2A/3	685	810 [890]	306	385	203	31	111.5	63	136	23	B-49	167.5	510
	1	KF 100S1A/3	675	915 [955]	306	385	203	31	111.5	63	136	23	B-49	167.5	510
	2	KF 100S2A/3	860	1030 [1070]	342	395	236	37	124.5	75	150	31	B-56	171.5	510

- Le dimensioni () della quota "D" è riferita a paranchi con sacco raccogliacatena grande.
- Dimensions in brackets for measure "D" are data for large size chain container.