

Kit sicurezze tipo 2DS (tipo pesante)

2DS heavy type safety latches

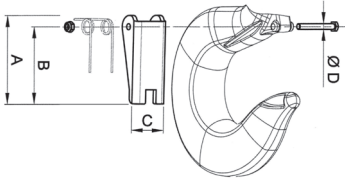

| Codice Code | Marcatura Marking | Portata ganci Hooks WLL | Portata ganci Hooks WLL | Dimensioni Dimensions | | | |
|----------------|----------------------|----------------------------|----------------------------|--------------------------|---------|---------|---------|
| | | GNOG-GNSC-GNIC t | GOA-GNSA-GNIA t | A mm | B mm | C mm | D mm |
| 2DS0D1 | D1 | 0,8 | 1,25 | 39,5 | 32,5 | 17 | 4 |
| 2DS0D2 | D2 | 1 | 1,6 | 43,5 | 35,5 | 23 | 4 |
| 2DS0D3 | D3 | 1,6 - 2 | 2,5 - 3,2 | 49 | 41 | 25 | 5 |
| 2DS0D4 | D4 | 3,2 | 5,4 | 61,5 | 51,5 | 29 | 5 |
| 2DS0D5 | D5 | 5 | 8 | 77,5 | 67,5 | 35 | 6 |
| 2DS0D6 | D6 | 7,5 | 11,5 | 87 | 76 | 37 | 6 |
| 2DS0D7 | D7 | 10 | 16 | 96 | 85,5 | 49 | 6 |
| 2DS0D8 | D8 | 15 | 22 | 131 | 116 | 54 | 6 |
| 2DS0D9 | D9 | 20 | 30 | 152,5 | 135 | 64 | 8 |

Kit sicurezze tipo ST3 (tipo pesante)

ST3 heavy type safety latches

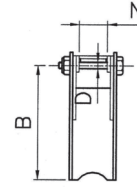

| Codice Code | Marcatura Marking | Portata ganci Hooks WLL | Portata ganci Hooks WLL | Dimensioni Dimensions | | |
|----------------|----------------------|----------------------------|----------------------------|--------------------------|---------|---------|
| | | GNOG-GNSC-GNIC t | GOA-GNSA-GNIA t | B mm | D mm | N mm |
| AST301 | ST301 | 0,8 | 1,25 | 34 | 4 | 7,4 |
| AST301 | ST301 | 1 | 1,6 | 34 | 4 | 7,4 |
| AST303 | ST303 | 1,6 | 2,5 | 39 | 4 | 11,1 |
| AST304 | ST304 | 2 | 3,2 | 41 | 4 | 11,1 |
| AST305 | ST305 | 3,2 | 5,4 | 50 | 4 | 11,1 |
| AST306 | ST306 | 5 | 8 | 68 | 6 | 16,2 |
| AST307 | ST307 | 7,5 | 11,5 | 75 | 6 | 17,7 |
| AST308 | ST308 | 10 | 16 | 84 | 6 | 23 |
| AST309 | ST309 | 15 | 22 | 115 | 6 | 23 |

Kit sicurezze tipo ST2 (tipo leggero)

ST2 light type safety latches

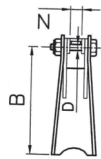

| Codice Code | Marcatura Marking | Portata ganci Hooks WLL | Portata ganci Hooks WLL | Portata ganci Hooks WLL | Portata ganci Hooks WLL | Dimensioni Dimensions | | |
|----------------|----------------------|----------------------------|----------------------------|----------------------------|----------------------------|--------------------------|---------|---------|
| | | GNOG-GNSC-GNIC t | GOA-GNSA-GNIA t | G1-G2 kg | UNI 4395 kg | B mm | D mm | N mm |
| AST201 | ST201 | 0,8 | 1,25 | | | 32 | 4 | 7,9 |
| AST202 | ST202 | 1 | 1,6 | | | 36 | 4 | 7,9 |
| AST203 | ST203 | 1,6 | 2,5 | | | 40 | 4 | 6 |
| AST204 | ST204 | 2 | 3,2 | 100 | | 45 | 4 | 6 |
| AST205 | ST205 | | | | 0,8 | 49 | 4 | 7 |
| AST206 | ST206 | 3,2 | 5,4 | 150 - 200 | | 53 | 4 | 8 |
| AST207 | ST207 | | | | 1 | 60 | 5 | 11,1 |
| AST208 | ST208 | 5 | 8 | | 1,6 | 70 | 5 | 11,1 |
| AST209 | ST209 | | | 350 | 2 | 75 | 6 | 11,1 |
| AST212 | ST212 | 7,5 | 11,5 | 500 | 2,5 | 81 | 6 | 16,7 |
| AST213 | ST213 | 10 | 16 | 650 - 800 | 3,2 - 4 - 5 | 90 | 6 | 16,7 |
| AST215 | ST215 | 20 | 30 | 1000 - 1500 | | 134 | 6 | 24 |

Sicurezze tipo pesante per ganci DIN

Heavy type latches for DIN hooks

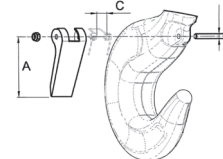

| Codice Code | Per gancio grandezza For hook size | | Dimensioni Dimensions | | |
|----------------|---------------------------------------|--------------|--------------------------|---------|---------|
| | DIN 15401 | DIN 15402 | A mm | C mm | D mm |
| 2DS002 | 012 | - | 35,5 | 10 | M4 |
| 2DS003 | 025 | - | 41 | 11 | M4 |
| 2DS004 | 05 | - | 51,5 | 13 | M5 |
| 2DS005 | 08+1 | - | 67,5 | 13 | M5 |
| 2DS0A6 | - | 2,5 | 81 | 17 | M6 |
| 2DS006 | 1,6+2,5 | - | 75 | 17 | M6 |
| 2DS007 | 4 | 4 | 84 | 20 | M6 |
| 2DIN05 | 5 | 6 | 96 | 20 | M10 |
| 2DIN06 | 6 | 8 | 106 | 20 | M10 |
| 2DIN08 | 8 | 10 | 122 | 25 | M12 |
| 2DIN10 | 10 | 12 | 132 | 25 | M12 |
| 2DIN12 | 12 | 16 | 150 | 30 | M16 |
| 1DIN16 | 16 | 20 | 170 | 35 | M16 |
| 1DIN21 | 20 | 25 | 198 | 40 | M16 |
| 1DIN26 | 25 | 32 | 212 | 40 | M16 |
| 1DIN33 | 32 | 40 | 236 | 50 | M20 |
| 1DIN41 | 40 | 50 | 265 | 54 | M20 |
| 1DIN51 | 50 | 63 | 300 | 54 | M24 |
| 1DIN64 | 63 | 80 | 335 | 54 | M24 |
| 1DIN83 | 80 | 100 | 375 | 54 | M24 |
| 1DIN84 | 100 | 125 | 425 | 54 | M30 |

Kit sicurezze a caduta per ganci tipo UNI 4395

UNI 4395 hook safety latches

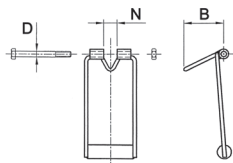

| Codice Code | Marcatura Marking | Portata WLL | Dimensioni Dimensions | | |
|----------------|----------------------|----------------|--------------------------|---------|---------|
| | | t | B mm | D mm | N mm |
| ASC202 | SC202 | 1 | 50 | 5 | 11 |
| ASC203 | SC203 | 1,6 | 70 | 5 | 11 |
| ASC203L | SC203L | 2 | 75 | 6 | 14 |
| ASC204 | SC204 | 2,5 | 80 | 6 | 18 |
| ASC205 | SC205 | 3,2 - 4 - 5 | 100 | 6 | 16 |